

PCB LAYOUT

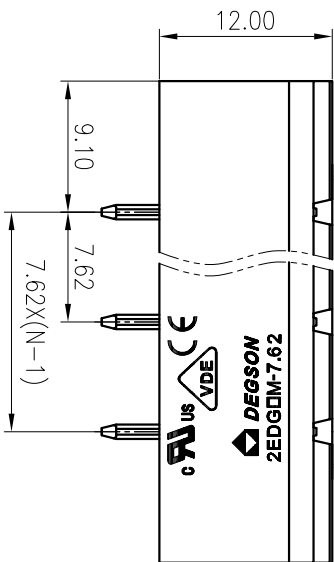
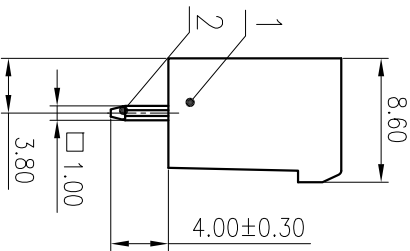
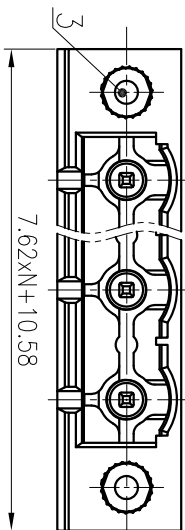
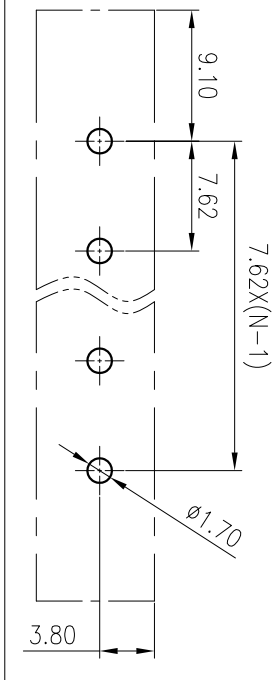

公差/General tolerances(mm)	
0	>3
3	>6
6	>10
10	>18
18	>30
30	>50
50	>80
80	>120
120	>180
250	>250
315	>315
400	>400
500	>500
±0.12	±0.18
±0.22	±0.26
±0.31	±0.37
±0.57	±0.80
±0.93	±1.05
±1.15	±1.60
±2.20	±2.50
±2	±2

3	Nut	Copper alloy	/
2	Pin	Copper	Sn Plated
1	Housing	PA66	UL94V-0
ITEM	NAME OF PART	MATERIAL	NOTES
UL 标准/UL Standard:		B	C
额定电压/Rated Voltage(V)	Current(A)	300/15	300/10
EC 标准/EC Standard:			
过压类别/Overvoltage Category/污染等级		III/3	III/2
级/Pollution Degree		/	400/20
额定电压/电压/Rated Voltage(V)/Current(A)		/	4
额定脉冲电压(KV)/Rate Impulse Voltage(KV)			N=02~12P
使用温度范围/Operating temperature(°C)			-40~+105
符合RoHS环保要求/Conform to RoHS			Yes

MATERIAL:		SURFACE:	
MAT NO.:	/		
STATUS:	/		
APPD: Ldn	ChH 2020.05.21		
CHKD:	/		
DRAFT: GongYzh	2020.05.21		
NAME:	2EDGVM-7.62-XXP-1Y-100A(H)		
DRAWING NO.:	10002012		
TYPE:	CUSTOMER DRAWING		
SCALE:	2:1		
REV	T0		
SHEET	1/1		

DEGSON 宁波高松电子有限公司
NINGBO DEGSON ELECTRICAL CO., LTD

2EDGVM-7.62-XXP-1Y-100A(H)

REV	ECN	DESCRIPTION	DRAFT	DATE

SIZE	SCALE
A4	2:1

TYPE: CUSTOMER DRAWING

SCALE	SHEET
2:1	1/1